

DESCRIPTION	REVISIONS	DATE

STR. NO. OR LOCATION	D.A.	DISTURBED AREA
98+85.00	1A	0.11 A.C.
98+85.00	1B	0.12 A.C.
TOTAL	1	0.23 A.C.

STR. NO. OR LOCATION	D.A.	DISTURBED AREA
1	2A	0.98 A.C.
1	2B	1.15 A.C.
TOTAL	2	2.13 A.C.

STR. NO. OR LOCATION	D.A.	DISTURBED AREA
3	3A	0.19 A.C.
3	3B	0.23 A.C.
3	3C	0.49 A.C.
3	3D	0.54 A.C.
TOTAL	3	1.45 A.C.

SUMMARY OF DISTURBED AREAS						
DISTURBED AREA NO.	OUTFALL STATION	STR. NO.	AREA AC.	SEDIMENT CONTROL MEASURES	DISTURBED AREA STA. TO STA.	STANDARDS
1	98+85.00	-	0.23	TEMPORARY SILT DIKE	98+85.00 TO 100+00.00	TSD-2-0
2	100+34.00	1	2.13	TEMPORARY SILT DIKE	100+00.00 TO 115+00.00	TSD-2-0
3	118+16.00	3	1.45	TEMPORARY SILT DIKE	115+00.00 TO 126+40.00	TSD-2-0
4	141+37.00	4	3.87	TEMPORARY SILT DIKE	126+40.00 TO 152+81.00	TSD-2-0
5	168+38.00	7	3.32	TEMPORARY SILT FENCE	152+81.00 TO 179+27.00	TSC2-3-2
6	191+75.00	11	1.48	TEMPORARY SILT FENCE	179+27.00 TO 191+75.00	TSC2-3-2
7	205+05.00	16	1.72	TEMPORARY SILT FENCE	191+75.00 TO 205+38.00	TSC2-3-2
8	205+70.00	17	0.65	TEMPORARY SILT FENCE	205+38.00 TO 210+00.00	TSC2-3-2
9	222+45.00	20	2.45	TEMPORARY SILT FENCE	210+00.00 TO 228+91.00	TSC2-3-2
10	245+34.00	-	1.06	TEMPORARY SILT FENCE	227+90.00 TO 245+34.00	TSC2-3-2
11	256+88.00	BRIDGE A	2.72	TEMPORARY SILT FENCE	228+91.00 TO 259+06.00	TSC2-3-2
12	259+06.00	31	4.84	TEMPORARY SILT DIKE	257+11.00 TO 293+00.00	TSD-2-0
13	297+00.00	-	1.00	TEMPORARY SILT FENCE	293+00.00 TO 308+00.00	TSC2-3-2
14	297+00.00	-	0.81	TEMPORARY SILT FENCE	293+00.00 TO 308+00.00	TSC2-3-3
15	311+30.00	44	0.55	TEMPORARY SILT DIKE	308+00.00 TO 311+66.00	TSD-2-0
16	311+96.00	45	2.30	TEMPORARY SILT DIKE	311+66.00 TO 328+86.00	TSD-2-0
17	338+42.00	49	2.05	TEMPORARY SILT DIKE	328+86.00 TO 344+00.00	TSD-2-0
18	363+26.48	-	1.47	TEMPORARY SILT DIKE	344+00.00 TO 363+26.48	TSD-2-0
19	363+26.48	-	1.34	TEMPORARY SILT DIKE	344+00.00 TO 363+26.82	TSD-2-0
TOTAL			35.44			

EROSION CONTROL QUANTITIES		
DESCRIPTION	UNITS	QUANTITY
TEMPORARY SILT FENCE	(1)	LF 11,334.00
TEMPORARY SILT DIKE	(1)	LF 721.00
SOLID SLAB SODDING	SY	96,335.00
VEGETATIVE MULCHING	(2)	AC 39.80
CLASS C CONCRETE	(3)	CY 50.00
TYPE I PLAIN RIPRAP	TON	1,805.00

LEGEND	
TEMPORARY SILT DIKE	
TEMPORARY SILT FENCE	
RIP RAP	
SOLID SLAB SOD DITCH	

- ESTIMATED QUANTITY FOR USE IN CONJUNCTION WITH THIS SHEET AND AS DIRECTED BY THE ENGINEER.
- QUANTITY BASED ON 19.90 ACRES AT TWO APPLICATIONS.
- QUANTITY INCLUDES 50 C.Y. FOR USE AS DIRECTED BY THE ENGINEER.

**EROSION CONTROL AND CONSTRUCTION NOTES**

SOLID SLAB SODDING SHALL BE PLACED ON ALL DISTURBED AREAS.

THE PLANTING OF SOLID SLAB SOD SHALL BE RESTRICTED TO THE PERIOD FROM MARCH 1 TO AUGUST 31.

AT THE BEGINNING OF TURFING OPERATIONS, ANY AREAS INCLUDED IN PLANNED QUANTITIES THAT HAVE GROWN A SATISFACTORY VOLUNTEER TURF OF PERENNIAL GRASS, AS DETERMINED BY THE ENGINEER, SHALL BE FERTILIZED AND WATERED AS CALLED FOR ON THE PLANS, BUT SHALL NOT BE SEEDED, SODDED, OR SPRIGGED.

VEGETATIVE MULCHING: VEGETATIVE MULCH SHALL BE ANCHORED IN ACCORDANCE WITH THE "MULCHING-TILLER METHOD" AS SPECIFIED IN SECTION 233.04(b) OF THE STANDARD SPECIFICATIONS.

TOPSOIL NOTE: RESERVED TOPSOIL SHALL BE SPREAD APPROX. 5 INCHES THICK FIRST ON COMPLETED FORE SLOPES OF FILL SECTIONS AND THE REMAINDER ON COMPLETED CUT SLOPES OR OTHER PRIORITY AREAS LOCATED BY THE ENGINEER.

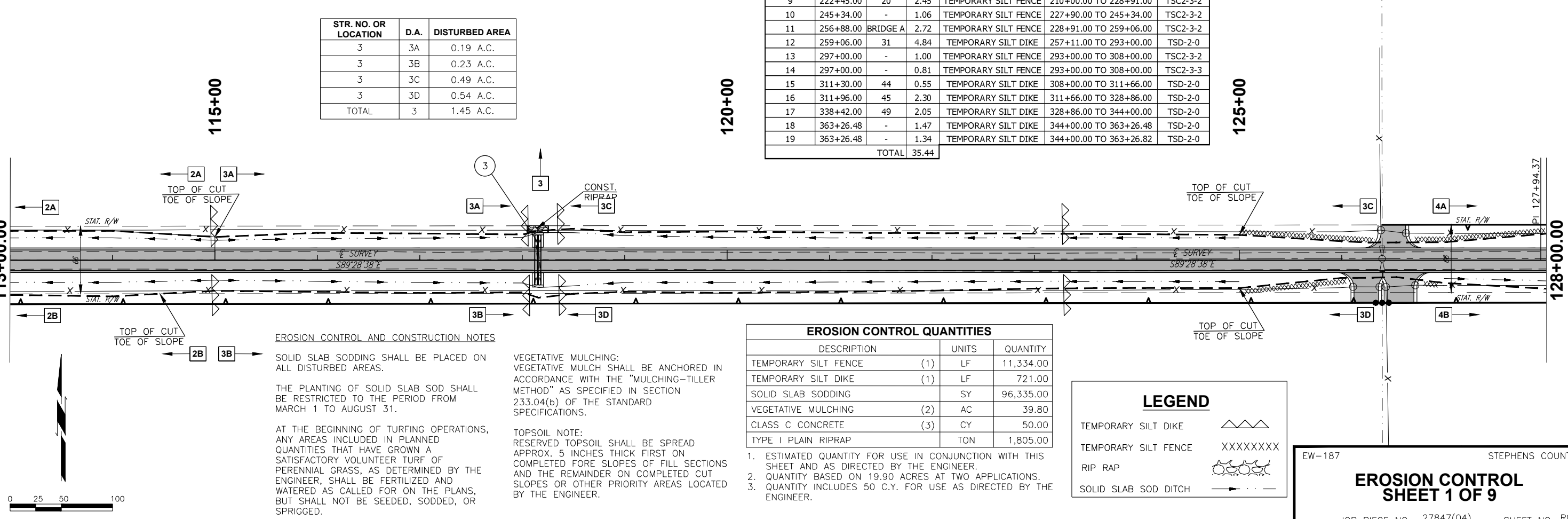
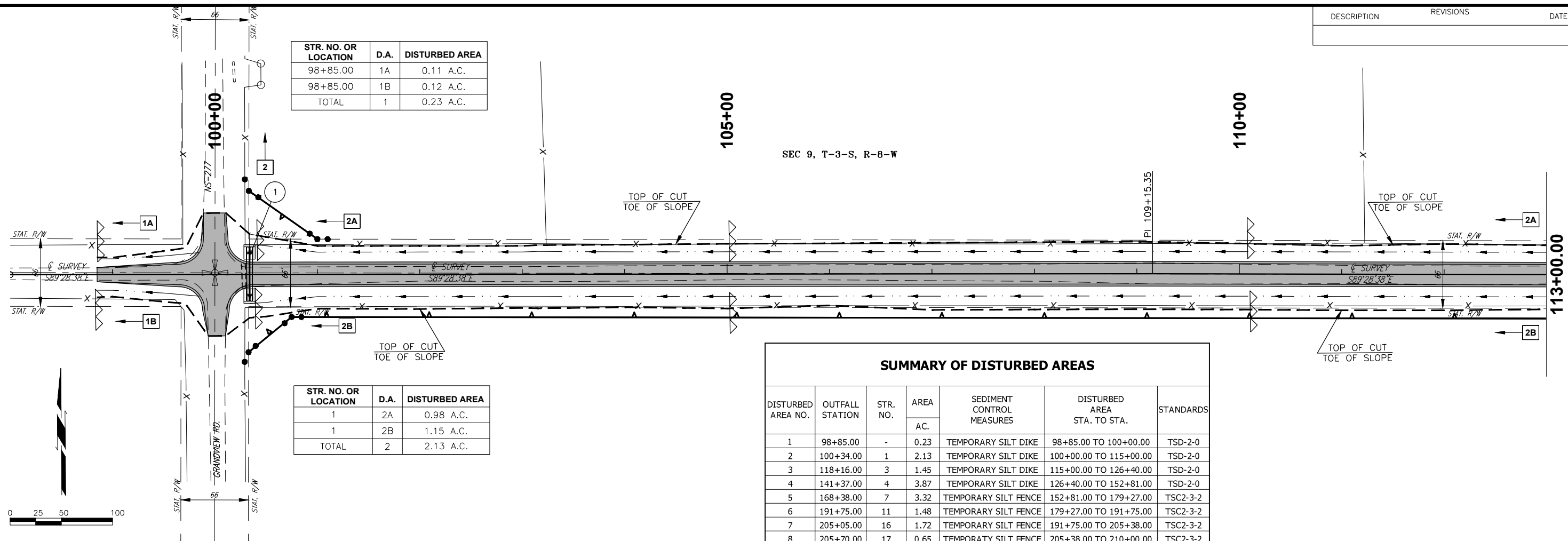

8/18/2017 4:06:31 PM N:\0\CS\TRANSPORTATION\COUNTY PRODUCTION\STEPHENS\12010\EW-187\STEPHENS\PROJECT DRAWINGS\EROSION CONTROL PLANS.DWG